

The **Norbulb N3.3** mm is a thermal release element for fire protection applications. The enclosed fluid will expand with rising temperature, increasing the internal pressure until the glass bulb bursts into small particles at the defined operating temperature.

The **N3.3** mm glass bulb is designed to meet the requirements of UL, FM, LPCB, VdS and TFRI for all Fast Response, Residential, ELO, Extended Coverage, Concealed, Dry Pendent and other special sprinkler applications. It is available in all common temperature ratings. The actuation temperature is within  $\pm 3.5\%$  of the nominal temperature ( $^{\circ}\text{F}$ ).

Colour Code	Nominal Temperature*	
	Celsius	Fahrenheit
Orange	57°C	135°F
Red	68°C	155°F
Yellow	79°C	175°F
Green	93°C	200°F
Blue	141°C	286°F

\* further temperatures on request

The internally reinforced ends, conical reduced towards the mid-section, allow a smooth transition of high assembly forces directly into the shaft. This novel design gives the **N3.3** mm glass bulb a slender appearance, highly sensitive, yet strong and robust.

Strength*	kN		lb	
	regular	XS	regular	XS
Average >	4.0	5.0	880	1100
LTL >	2.0	3.0	440	660

\* minimum values

The filling fluids used in our **N3.3** mm glass bulbs are patented (US Patent No. 5,890,543) and result in a superior Fast Response performance.

$RTI_c$ [ $c = 0,5(\text{m/s})^{1/2}$ ]	$38 \text{ ms}^{1/2}$	$68(\text{fts})^{1/2}$
---	-----------------------	------------------------

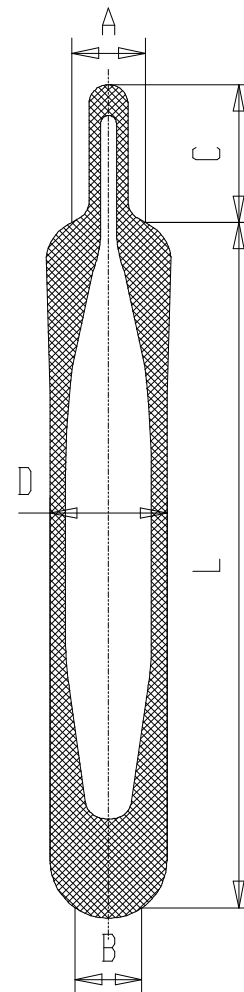

Do not scale

Dimensions	mm	inch
Diameter <b>D</b>	3.3	.130
Length <b>L</b>	19.5-20.5	.768-.807
Capillary <b>C</b>	max 4.0	max .157
Seat dia. <b>A</b>	2.8	.110
Seat dia. <b>B</b>	2.0	.080

The glass bulbs allow a safe self-aligning assembly and are compatible with all current seat designs. Technical Specification data for reference only. Right for alterations reserved

